

R E P O R T

ON THE PROPERTY OF THE

CHESTER MINING COMPANY,

LOCATED IN CHESTER TOWNSHIP,

CANADA EAST,

SEVEN AND A HALF MILES FROM THE

G R A N D T R U N K R A I L W A Y .

B O S T O N :

PRINTED BY ALFRED MUDGE & SON, 34 SCHOOL STREET.

1 8 6 4 .

PROPERTY OF THE CHESTER MINING CO.

Distance from the Mine to Arthabaska Station, on the Grand Trunk
Railway, seven and a half miles.

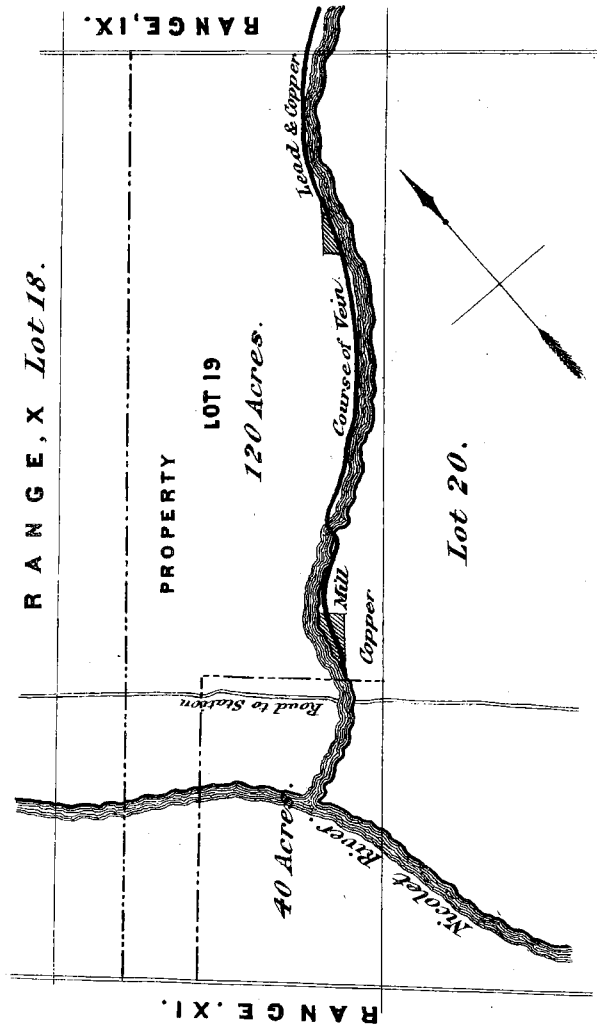

R E P O R T

ON THE PROPERTY OF THE

CHESTER MINING COMPANY,

LOCATED IN CHESTER TOWNSHIP,

CANADA EAST,

SEVEN AND A HALF MILES FROM THE

G R A N D T R U N K R A I L W A Y .



B O S T O N :

PRINTED BY ALFRED MUDGE & SON, 34 SCHOOL STREET.

1 8 6 4 .

CHESTER MINING COMPANY,

ORGANIZED UNDER THE REVISED STATUTES OF MASSACHUSETTS.

Capital Stock Two Hundred Thousand Dollars.

OFFICERS.

PRESIDENT.

E. G. LUCAS.

TREASURER AND CLERK.

ALBERT CASE.

DIRECTORS.

E. G. LUCAS, F. W. PELTON,
A. C. FELTON, ABNER FRENCH,
JULIUS PELTON.

OFFICE, NO. 7, PHOENIX BUILDING, BOSTON.

BOSTON, JAN. 8, 1864.

To the Stockholders of the Chester Mining Company :

GENTLEMEN :

It is due to those interested in the Chester Mine, to say that the officers of the Company have perfect confidence in the actual richness and consequent value of the mine, and it is their intention and purpose to develop it fully and make it an actual dividend-paying stock.

Located as it is, within seven and a half miles of the Arthabaska station on the Grand Trunk Railway, with which it connects by good roads, the facilities for reaching market with the ore are unequalled by most of the mines in that region.

They have fixed the capital at \$200,000, which is moderate compared with other Canada companies. A large portion of the stock is held by the Company itself, and by parties in Canada; and it is hoped and expected that the stockholders in Boston, as well as in New York, will feel such strong confidence in the real value of the mine, that they will prefer to hold their stock for dividends, and not regard it as a mere stock speculation.

Respectfully,

ALBERT CASE,

Treasurer.

NO. 7. PHOENIX BUILDING, BOSTON.

REPORT

ON THE

CHESTER COPPER MINE.

53 ST. FRANCOIS XAVIER STREET, {
MONTREAL, 14TH JAN. 1864. }

GENTLEMEN :

I have visited the copper mining location in Chester, C. E., in which you are interested, being part of the 19th lot in the 10th range of that Township, and containing 120 acres. I have, on a previous occasion, forwarded to you a map, showing the position of the lot, etc., and now beg to submit the following brief report, drawn up from a very cursory examination of the property in the month of October last.

The underlying rock of the country is chloritic slate, interstratified with dolomitic limestone, and belonging to what has been styled by Sir William Logan, the Quebec group of the Lower Silurian System, and which,

in this, as in most other parts of the world, constitutes the great copper-bearing formation. This mining location lies on the line of a great band or belt of cupriferous rock, extending in a northeasterly direction from the province line in Sutton to the Chaudière River, and embracing nearly all the most important and promising copper mines in Lower Canada. In this and the adjoining townships of Halifax, Inverness, and Leeds, in particular, the rocks have been proved to be highly productive of copper and other valuable ores.

On this lot the copper ore, consisting chiefly of the yellow sulphuret (which is well known to be the most persistent), occurs in a thick vein of quartz, associated with chlorite, calc-spar, bitter-spar, embedded in the slates, and running N. 40° E. with a dip to the N. W. at an angle of about 45° . The direction of the length of the lot corresponds with that of the vein, which will thus extend a distance of 200 rods on the property. The course of the vein also coincides with that of a stream running lengthways through the lot; and, in fact, there seems reason to believe that this stream runs on the line of a fault or slide in the stratification which is undoubtedly a highly favorable feature in the prospects of this mining location, as indicating a probable concentration of metallic ores along such line of

fault. This vein has been traced by me for nearly two miles along this stream and everywhere presents the same favorable indications for mining.

This vein of copper-bearing quartz has been exposed by blasting on this property at two points, the first about fifty rods from the northeast end of the lot, and the other close to the road bounding the southwest end, and in both cases close to the bed of the creek; there can be little doubt that the vein is continuous between these two points. At the former opening it is about two feet thick, and yielded many rich specimens of yellow copper ore, and also considerable bunches of galena or lead ore. At the other the vein is very much thicker — probably not less than five or six feet; although, with the limited amount of work done, it is impossible to state what proportion of ore it may yield. In addition to the yellow ore in the quartz, rich vitreous sulphurets are found in the adjoining slate rock, and much green carbonate and many loose stones of ore on the surface.

I have carefully examined many similar localities in the Eastern Townships of Canada, and have no doubt that this will form no exception to the general rule, namely, that the ore lies in belts of the cupriferous slate, where it has been fissured, and the openings

subsequently filled with siliceous and calcareous matter, and with metallic ores. I find, generally, four sets of these copper-bearing bands or belts of slate within a short distance of and parallel to each other; and I entertain no doubt that this property will be traversed by others besides that discovered, and above described.

I regard the indications on this property, and the work done so far, as highly encouraging, and amply sufficient to justify further exploration upon an extensive scale.

The property is favorably situated as regards drainage, and the creek referred to affords an ample supply of water at all seasons for washing ores and of power for crushing, etc.

The lot is distant about seven miles and a half from a station on the Grand Trunk Railway, with good roads; wages of labor remarkably low, the French *habitans*, who have a remarkable aptitude for mining work, being willing to work at a very low rate of wages.

I have the honor to be, gentlemen,

Your most obedient servant,

CHARLES ROBB,

Mining Engineer.

